

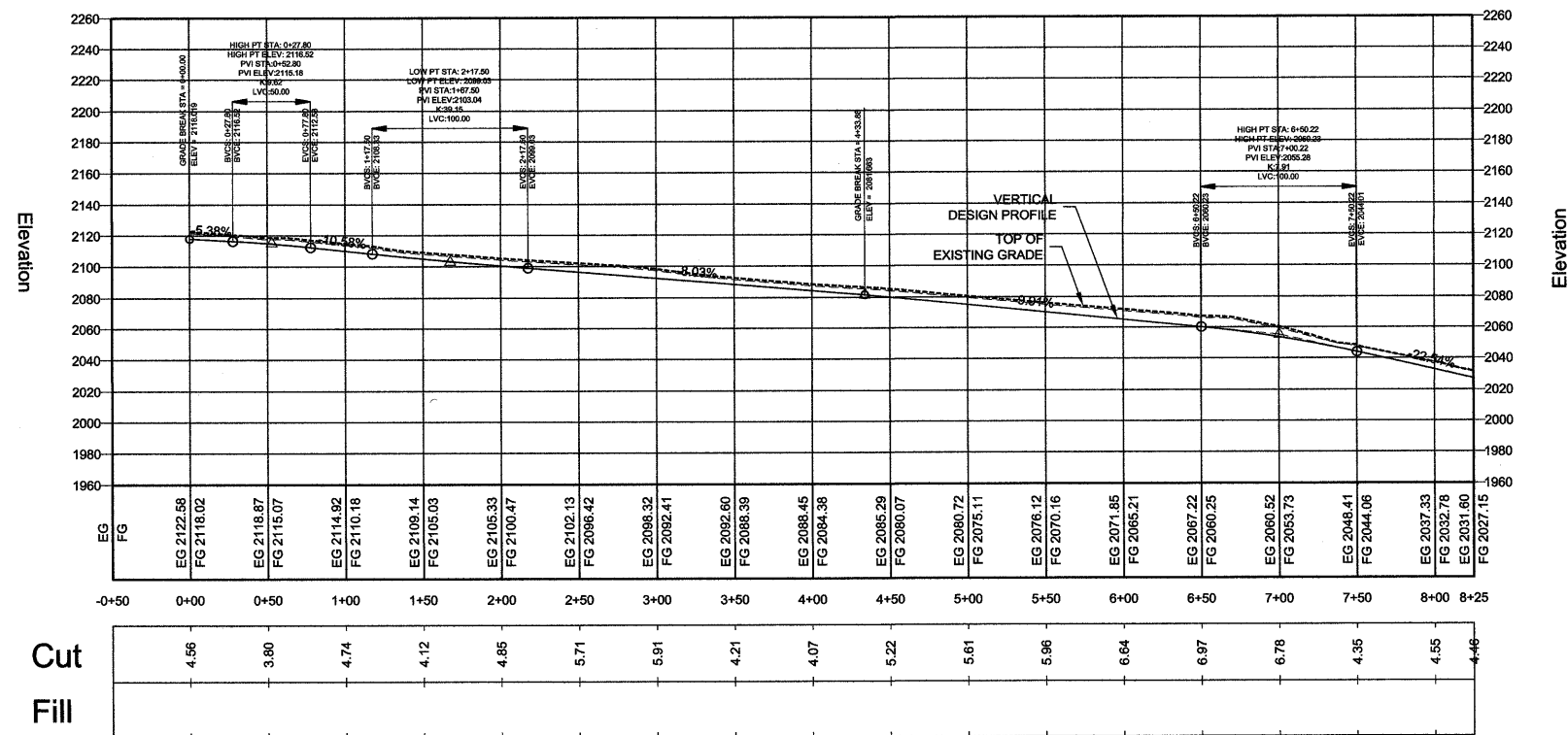

River	HEC-RAS River Station	Plan Station	Clear Flow (cfs)	Min Ch Elev (MSL)	W.S. Elev (MSL)	Flow Depth (ft)	Channel Depth (ft)	Critical Depth (ft)	E.G. Elev (MSL)	Top Width (ft)	Vel Chnl (ft/s)	Froude #	Mannings N	Controlling Freeboard (ft)	Max Super Elevation (ft)	Min Curve Radius 50 ft min	Excess Bank Freeboard (ft)
C-W2	1771	0	132.9	2118	2118.7	0.72	3.0	1.57	2122.8	12.88	16.15	3.56	0.03	1.88	0.52	200	0.4
C-W2	1697	69	132.9	2113.3	2114.2	0.93	3.0	1.57	2116.5	13.74	11.99	2.35	0.03	1.60	0.31	200	0.5
C-W2	1622	144	132.9	2105.5	2106.4	0.87	3.0	1.57	2109	13.48	13.01	2.63	0.03	1.66	0.35	200	0.5
C-W2	1547	221	132.9	2098.8	2099.7	0.93	3.0	1.57	2102	13.71	12.1	2.38	0.03	1.61	0.31	200	0.5
C-W2	1472	296	132.9	2092.8	2093.7	0.94	3.0	1.57	2096	13.75	11.92	2.33	0.03	1.60	0.30	200	0.5
C-W2	1397	371	132.9	2086.8	2087.7	0.94	3.0	1.57	2090	13.75	11.92	2.33	0.03	1.60	0.30	200	0.5
C-W2	1322	446	190.9	2080.6	2081.8	1.15	3.0	1.95	2084.6	14.62	13.44	2.4	0.03	1.76	0.41	200	0.1
C-W2	1247	520	190.9	2073.1	2074.2	1.09	3.0	1.95	2077.4	14.34	14.46	2.66	0.03	1.84	0.47	200	0.1
C-W2	1172	595	190.9	2065.7	2066.8	1.12	3.0	1.95	2069.8	14.49	13.89	2.51	0.03	1.79	0.43	200	0.1
C-W2	1121	646	190.9	2060.3	2061.2	0.89	3.0	1.95	2066.4	13.56	18.22	3.65	0.015	2.14	0.70	200	0.0
C-W2A	1097	670	190.9	2058	2058.8	0.83	5.0	1.95	2064.9	13.32	19.72	4.08	0.015	2.27	0.80	200	1.9
C-W2A	1021	746	190.9	2044.1	2044.7	0.62	5.0	1.95	2056.3	12.49	27.32	6.43	0.015	3.03	1.45	200	1.4
C-W2A	947	820	190.9	2028.3	2028.9	0.59	5.0	1.95	2042.1	12.34	29.2	7.07	0.015	3.25	1.63	200	1.2

CW2

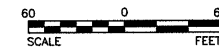

Cut
Fill

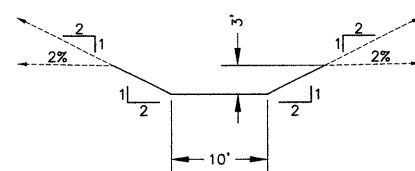

C-W2
STA. 00+00 TO 6+00.00

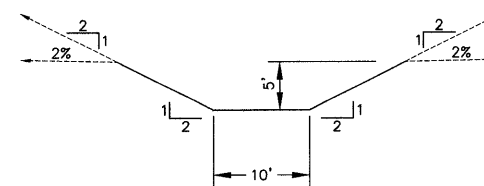

C-W2
STA. 6+50.00 TO 8+25.00

LEGEND

- AREA SHOWN TO RECEIVE 14-INCH EROSION LAYER. ALL OTHER AREAS TO RECEIVE 13-INCH EROSION LAYER.
- APPROX. LIMIT OF WASTE

NOTE

- SEE SHEET B7 FOR DITCH AND BERM GEOMETRY

REV	DATE	DES	REVISION DESCRIPTION	CADD	CHK	RW
7/1/11	JP		REISSUED FOR PERMITTING/CONSTRUCTION	ML	MB	RW
2/24/11	JP		REVISED DITCH SECTIONS	ML	MB	RW
2/24/11	JP		ISSUED FOR PERMITTING/CONSTRUCTION	ML	MB	RW
6/2/10	JP		ADDENDUM-ADJUSTED WEST BASIN CHANNEL GRADING	ML	AN	RW
5/5/10	JP		ISSUED FOR BIDDING	ML	KH	RW



PROJECT
REPUBLIC SERVICES, INC.
SUNRISE MOUNTAIN LANDFILL
LAS VEGAS, NEVADA

TITLE
C-W2 STA. 00+00 TO 8+25

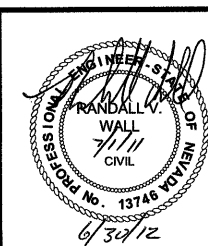

	PROJECT No.	093-97432	FILE No.	093-97432
	DESIGN	JP	2/24/11	SCALE AS SHOWN
	CADD	ML	2/24/11	REV. 3
	CHECK	AN	2/24/11	
	REVIEW	RW	2/24/11	

CW1

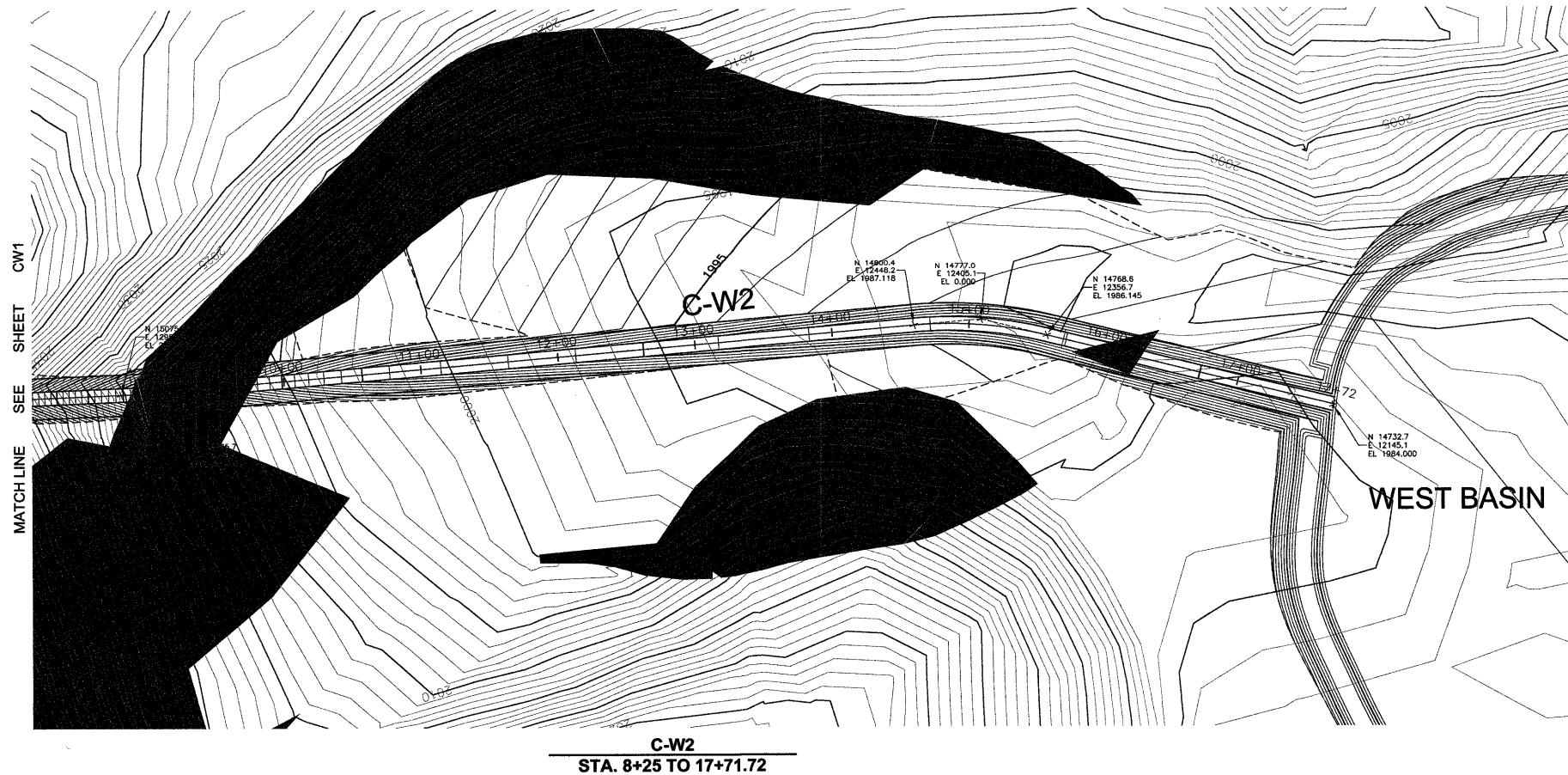

River	HEC-RAS Station	Plan Station	Clear Flow (cfs)	Min Ch Elev (MSL)	W.S. Elev (MSL)	Flow Depth (ft)	Channel Depth (ft)	Critical Depth (ft)	E.G. Elev (MSL)	Top Width (ft)	Vel Chnl (ft/s)	Froude #	Manning's N	Controling Freeboard (ft)	Max Super Elevation (ft)	Min Curve Radius 50 ft min	Excess Bank Freeboard (ft)
C-W2A	947	820	190.9	2028.3	2028.89	0.59	5.0	1.95	2042.13	12.34	29.2	7.07	0.015	3.25	1.63	200	1.2
C-W2A	872	895	337	2012.9	2013.81	0.91	5.0	2.7	2029.22	13.62	31.51	6.27	0.015	4.10	2.10	200	0.0
C-W2A	797	970	337	2003.2	2004.14	0.94	5.0	2.71	2018.15	13.78	30.04	5.86	0.015	3.93	1.93	200	0.1
C-W2A	722	1045	337	1995.8	1996.81	1.01	5.0	2.71	2008.88	14.02	27.88	5.29	0.015	3.69	1.69	200	0.3
C-W2A	647	1120	337	1992.9	1994.11	1.21	5.0	2.71	2001.86	14.86	22.33	3.9	0.015	3.15	1.15	200	0.6
C-W2A	572	1195	337	1991.4	1992.81	1.41	5.0	2.71	1998.19	15.65	18.62	3.05	0.015	2.84	0.84	200	0.7
C-W2A	497	1270	337	1989.9	1991.42	1.52	5.0	2.71	1995.92	16.07	17.02	2.7	0.015	2.72	0.72	200	0.8
C-W2A	422	1345	337	1988.6	1990.21	1.61	5.0	2.71	1994.13	16.42	15.89	2.46	0.015	2.64	0.64	200	0.7
C-W2A	347	1420	337	1987.5	1989.19	1.69	5.0	2.71	1992.64	16.76	14.91	2.26	0.015	2.58	0.58	200	0.7
C-W2A	272	1495	337	1986.8	1988.64	1.84	5.0	2.71	1991.42	17.37	13.37	1.96	0.015	2.48	0.48	200	0.7
C-W2A	197	1570	337	1986	1987.88	1.88	5.0	2.71	1990.51	17.53	13	1.88	0.015	2.46	0.46	200	0.7
C-W2A	122	1645	337	1985.3	1987.25	1.95	5.0	2.71	1989.65	17.8	12.43	1.78	0.015	2.43	0.43	200	0.6
C-W2A	47	1720	337	1984.5	1986.44	1.94	5.0	2.71	1988.88	17.74	12.55	1.8	0.015	2.43	0.43	200	0.6
C-W2A	22	1745	337	1984.3	1986.26	1.96	5.0	2.71	1988.63	17.84	12.34	1.76	0.015	2.42	0.42	200	0.6
C-W2A	0	1767	337	1984	1985.93	1.93	5.0	2.71	1988.4	17.71	12.62	1.81	0.015	2.44	0.44	200	0.6

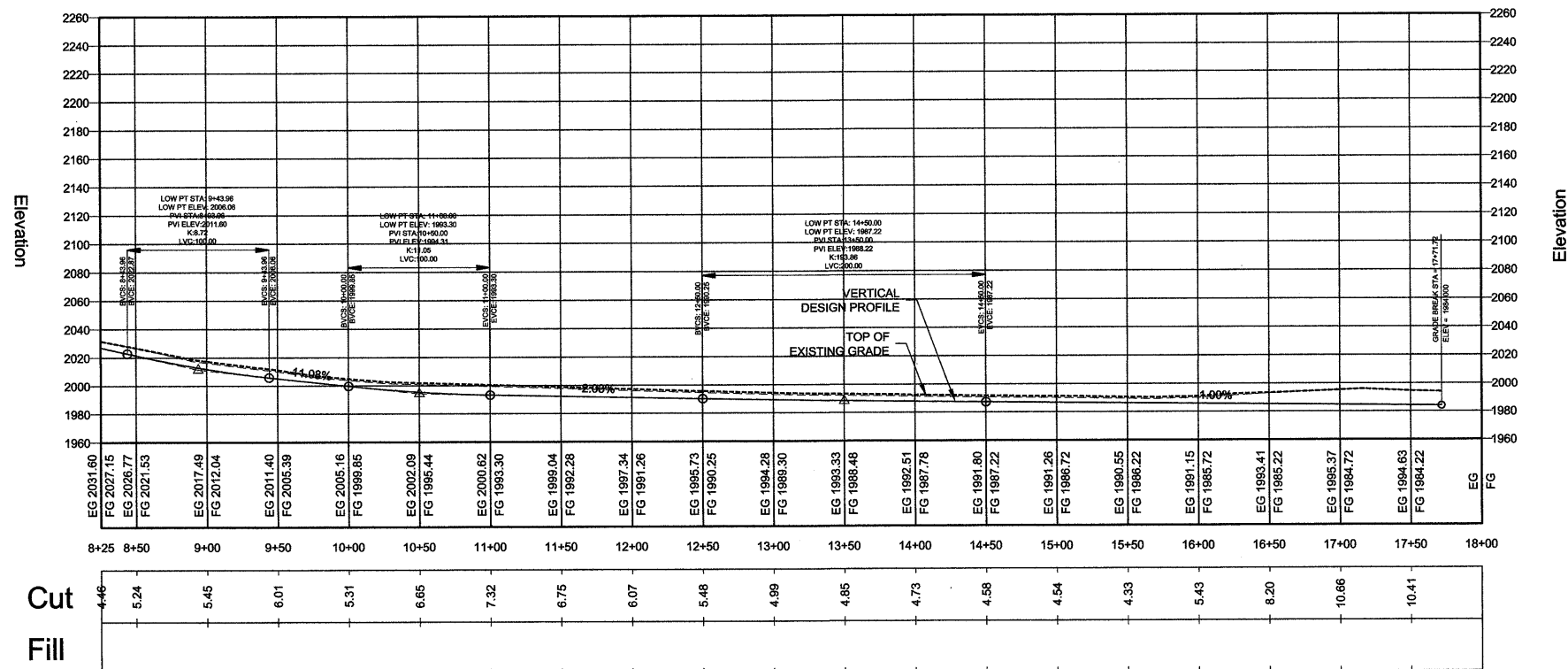
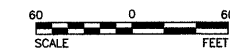

LEGEND

- AREA SHOWN TO RECEIVE 14-INCH EROSION LAYER. ALL OTHER AREAS TO RECEIVE 13-INCH EROSION LAYER.
- APPROX. LIMIT OF WASTE

NOTE

- SEE SHEET B7 FOR DITCH AND BERM GEOMETRY

REV	DATE	DES	REVISION DESCRIPTION	CADD	CHK	RW
7/1/11	JP		REISSUED FOR PERMITTING/CONSTRUCTION	ML	MB	RW
3/10/11	JP		REVISED DITCH SECTION	ML	MB	RW
2/24/11	JP		ISSUED FOR PERMITTING/CONSTRUCTION	ML	MB	RW
6/2/10	JP		ADDENDUM-ADJUSTED WEST BASIN CHANNEL GRADING	ML	AN	RW
5/5/10	JP		ISSUED FOR BIDDING	ML	KH	RW



PROJECT
REPUBLIC SERVICES, INC.
SUNRISE MOUNTAIN LANDFILL
LAS VEGAS, NEVADA

TITLE
C-W2 STA. 8+25 TO 17+71.72

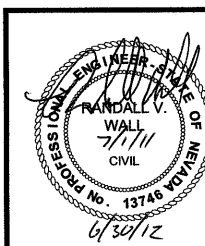

PROJECT No.	093-97432	FILE No.	093-97432
DESIGN	JP	SCALE	AS SHOWN
CADD	ML	REV.	3
CHECK	AN		
REVIEW	RW		

CW2

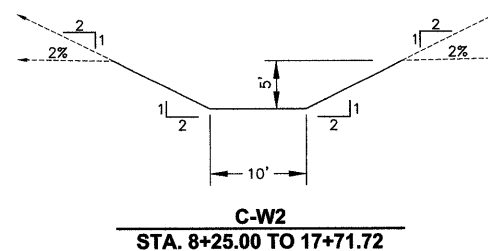

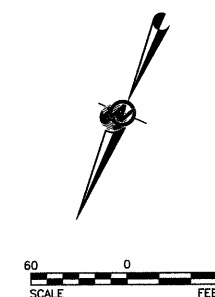
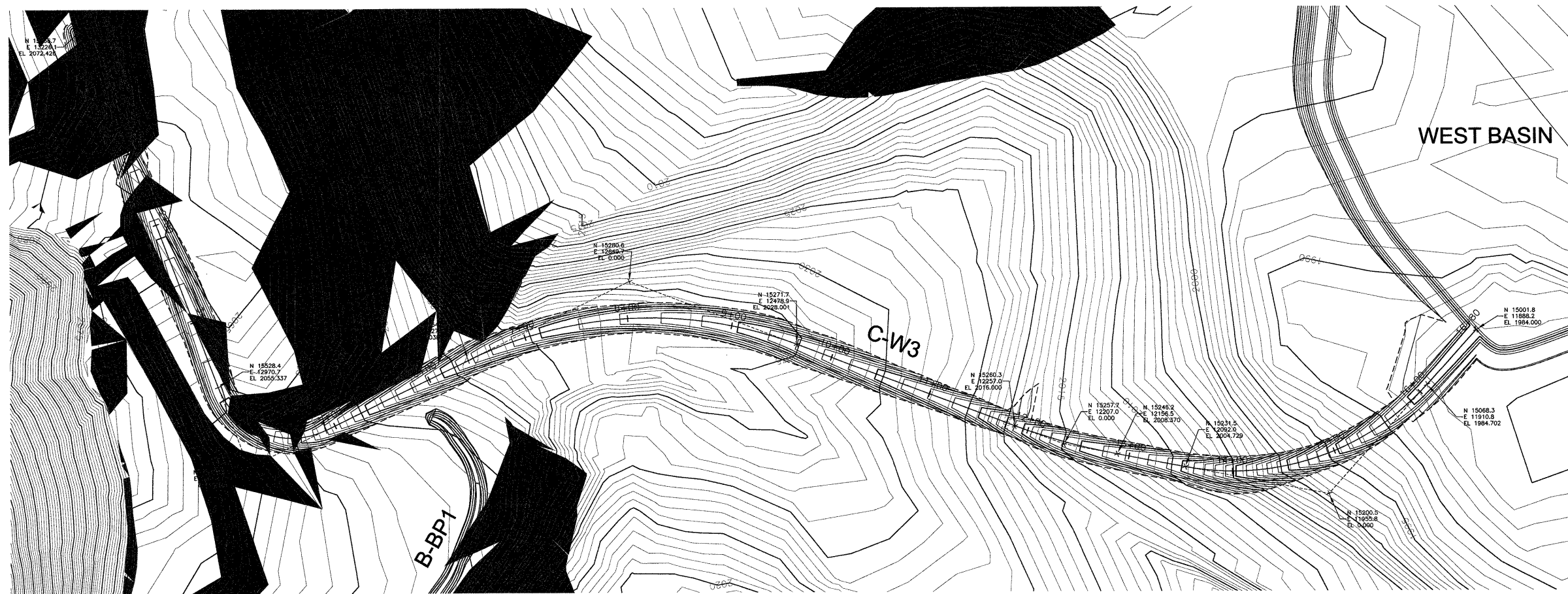

C-W3
STA. 00+00 TO 16+79.76

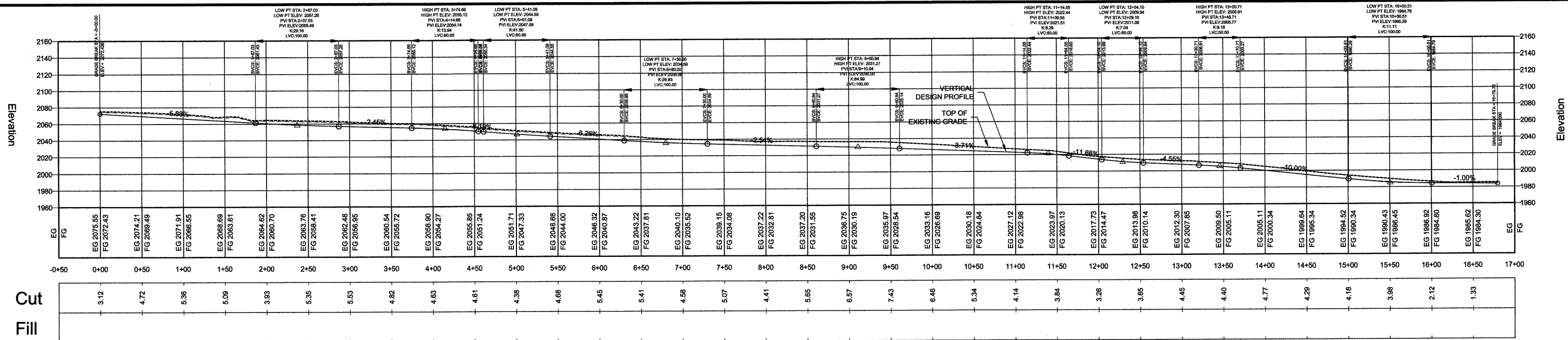

LEGEND

- AREA SHOWN TO RECEIVE 14-INCH EROSION LAYER.
ALL OTHER AREAS TO RECEIVE 13-INCH EROSION LAYER.
- APPROX. LIMIT OF WASTE

NOTE

1. SEE SHEET B7 FOR DITCH AND BERM GEOMETRY

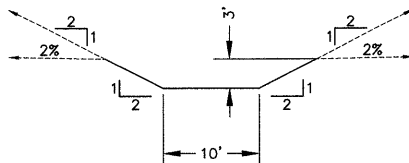

C-W3
STA. 00+00 TO 16+79.76

River	HEC-RAS Station	Plan Station	Clear Flow (cfs)	Min Ch Elev (MSL)	W.S. Elev (MSL)	Flow Depth (ft)	Channel Depth (ft)	Critical Depth (ft)	E.G. Elev (MSL)	Top Width (ft)	Vel Chnl (ft/s)	Froude #	Manning's N	Controllin g Freeboard (ft)	Max Super Elevation (ft)	Min Curve Radius 50 ft min	Excess Bank Freeboard (ft)
C-W3	1690	0	103.9	2072.43	2073.24	0.81	3.0	1.35	2075.11	13.25	10.98	2.29	0.03	1.26	-	NA	0.9
C-W3	1620	70	103.9	2068.31	2069.2	0.89	3.0	1.35	2070.72	13.56	9.9	1.98	0.03	1.24	-	NA	0.9
C-W3	1545	145	103.9	2063.9	2064.79	0.89	3.0	1.35	2066.32	13.56	9.91	1.99	0.03	1.24	-	NA	0.9
C-W3	1470	220	103.9	2059.68	2060.61	0.93	3.0	1.35	2061.98	13.72	9.42	1.85	0.03	1.73	0.50	75	0.3
C-W3	1395	295	103.9	2057.07	2058.22	1.15	3.0	1.35	2059.06	14.58	7.38	1.32	0.03	1.52	0.33	75	0.3
C-W3	1320	370	103.9	2055.23	2056.38	1.15	3.0	1.35	2057.22	14.6	7.35	1.32	0.03	1.52	0.33	75	0.3
C-W3	1245	445	103.9	2051.99	2052.88	0.89	3.0	1.35	2054.39	13.57	9.87	1.98	0.03	1.78	0.55	75	0.3
C-W3	1167	523	103.9	2046.27	2047.11	0.84	3.0	1.35	2048.85	13.36	10.59	2.18	0.03	1.87	0.62	75	0.3
C-W3	1092	598	103.9	2041.49	2042.37	0.88	3.0	1.35	2043.96	13.5	10.12	2.04	0.03	1.81	0.57	75	0.3
C-W3	1017	673	103.9	2037.02	2037.94	0.92	3.0	1.35	2039.37	13.66	9.61	1.9	0.03	1.76	0.52	75	0.3
C-W3	943	741	103.9	2034.33	2035.47	1.14	3.0	1.35	2036.34	14.53	7.47	1.35	0.03	1.53	0.34	75	0.3
C-W3	869	815	103.9	2032.43	2033.56	1.13	3.0	1.35	2034.44	14.52	7.51	1.35	0.03	1.53	0.34	75	0.3
C-W3	795	889	103.9	2030.48	2031.59	1.11	3.0	1.35	2032.5	14.44	7.66	1.39	0.03	1.55	0.35	75	0.3
C-W3	716	968	103.9	2027.81	2028.83	1.02	3.0	1.35	2029.94	14.09	8.44	1.59	0.03	1.83	0.42	75	0.4
C-W3	641	1043	103.9	2025.02	2026.04	1.02	3.0	1.35	2027.16	14.06	8.51	1.61	0.03	1.64	0.42	75	0.3
C-W3	566	1123	103.9	2022.22	2023.23	1.01	3.0	1.35	2024.36	14.05	8.54	1.62	0.03	1.64	0.42	75	0.4
C-W3	491	1198	103.9	2015.05	2015.78	0.73	3.0	1.35	2018.17	12.92	12.41	2.72	0.03	2.10	0.82	75	0.2
C-W3	415	1274	103.9	2009.22	2010.18	0.96	3.0	1.35	2011.45	13.86	9.04	1.75	0.03	1.69	0.47	75	0.3
C-W3	345	1344	103.9	2005.83	2006.74	0.91	3.0	1.35	2008.17	13.66	9.6	1.9	0.03	1.75	0.52	75	0.3
C-W3	269	1420	103.9	1998.84	1999.61	0.77	3.0	1.35	2001.75	13.07	11.74	2.51	0.03	2.01	0.75	75	0.2
C-W3	192	1497	103.9	1991.34	1992.11	0.77	3.0	1.35	1994.26	13.07	11.75	2.52	0.03	2.02	0.75	75	0.2
C-W3	116	1573	103.9	1985.72	1986.65	0.93	3.0	1.35	1988.01	13.74	9.37	1.84	0.03	1.73	0.50	75	0.3
C-W3	0	1689	103.9	1984.05	1985.41	1.36	3.0	1.36	1985.97	15.43	6.02	1	0.03	1.40	0.23	75	0.2

C-W3
STA. 00+00 TO 16+79.76

REV	DATE	DES	REVISION DESCRIPTION	CADD	CHK	RW
7/1/11	JP		REISSUED FOR PERMITTING/CONSTRUCTION	ML	MB	RW
3/11/10	JP		REVISED DITCH SECTION	ML	MB	RW
2/24/11	JP		ISSUED FOR PERMITTING/CONSTRUCTION	ML	MB	RW
5/5/10	JP		ISSUED FOR BIDDING	ML	AN	RW



PROJECT
REPUBLIC SERVICES, INC.
SUNRISE MOUNTAIN LANDFILL
LAS VEGAS, NEVADA

C-W3 STA. 00+00 TO 16+79.76

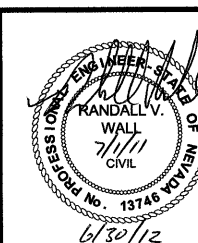

PROJECT No.	093-97432	FILE No.	093-97432
DESIGN	JP	2/24/11	SCALE AS SHOWN
CADD	ML	2/24/11	REV. 3
CHECK	AN	2/24/11	
REVIEW	RW	2/24/11	

CW3